

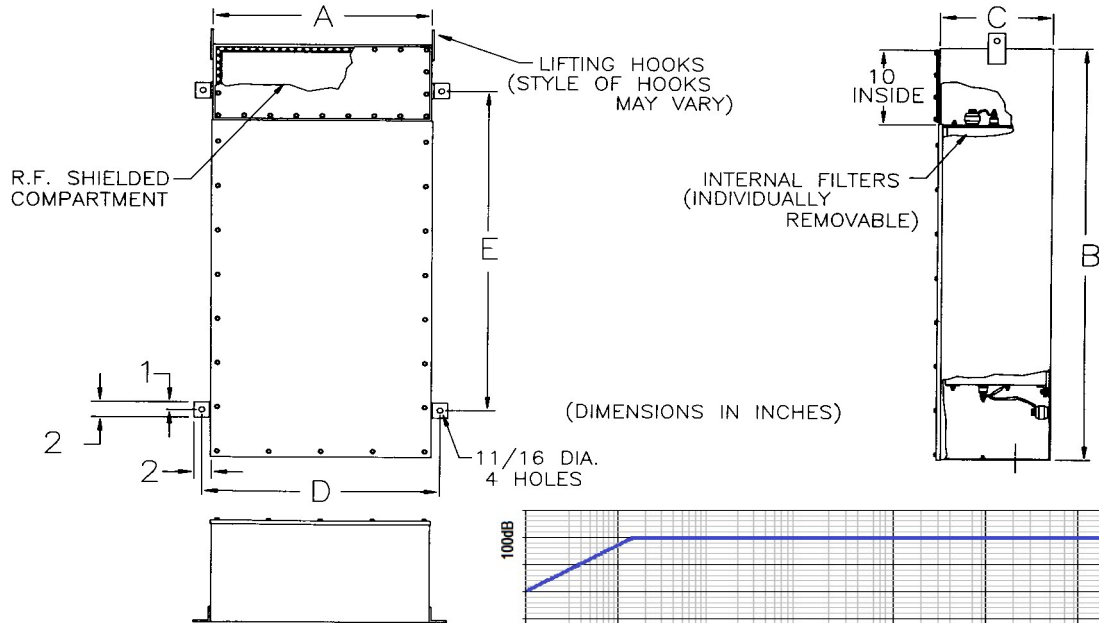

HEMP Filter Cabinets

For Tempest Application 100dB from 14kHz to 10GHz
IAW UL Safety Specification 1283



NOTES:

1. Filters are listed per UL specification #1283
2. Temperature Range: Operating -55°C to +85°C
3. Enclosures are made from cold rolled steel with continuously welded seams
4. Filter ground path connecting surfaces shall be tin plated or stainless steel
5. Conduit hubs or clearance holes may be provided if specified when ordering
6. Each phase filter is individually removable
7. Internal filters are filed with a non-flammable impregnant and hermetically sealed
8. Legs for floor mounting may be provided if specified when ordering
9. Filters for 300AMP and up have 6" x 2" mounting U-Channel

| Part Number | Current Rating (AMP) | Voltage Rating | | Frequency Rating (Hz) | Dimensions (INCHES) | | | | | Weight Approx. (LBS) |
|-----------------------|----------------------|----------------|-----|-----------------------|---------------------|--------|--------|--------|--------|----------------------|
| | | LG / LL VAC | VDC | | A±.060 | B±.060 | C±.060 | D±.060 | E±.060 | |
| FCULX-4 X 30E2 HEMP | 4 x 30 | 277 / 480 | 600 | 60 | 28 | 48 | 6 | 30 | 26 | 220 |
| FCULX-4 X 60E2 HEMP | 4 x 60 | 277 / 480 | 600 | 60 | 28 | 48 | 8 | 30 | 29 | 315 |
| FCULX-4 X 100E2 HEMP | 4 x 100 | 277 / 480 | 600 | 60 | 57 | 60 | 10 | 40 | 48 | 520 |
| FCULX-4 X 225E2 HEMP | 4 x 225 | 277 / 480 | 600 | 60 | 28 | 60 | 16 | 30 | 48 | 750 |
| FCULX-4 X 250E2 HEMP | 4 x 250 | 277 / 480 | 600 | 60 | 28 | 60 | 16 | 30 | 42 | 750 |
| FCULX-4 X 300E2 HEMP | 4 x 300 | 277 / 480 | 600 | 60 | 60 | 84 | 16 | 63 | 44 | 850 |
| FCULX-4 X 400E2 HEMP | 4 x 400 | 277 / 480 | 600 | 60 | 60 | 84 | 16 | 63 | 44 | 975 |
| FCULX-4 X 500E2 HEMP | 4 x 500 | 277 / 480 | 600 | 60 | 60 | 84 | 16 | 63 | 44 | 1075 |
| FCULX-4 X 600E2 HEMP | 4 x 600 | 277 / 480 | 600 | 60 | 45 | 84 | 34 | 48 | 44 | 1600 |
| FCULX-4 X 800E2 HEMP | 4 x 800 | 277 / 480 | 600 | 60 | 60 | 72 | 34 | 63 | 44 | 2400 |
| FCULX-4 X 1000E2 HEMP | 4 x 1000 | 277 / 480 | 600 | 60 | 60 | 72 | 34 | 63 | 44 | 2500 |
| FCULX-4 X 1200E2 HEMP | 4 x 1200 | 277 / 480 | 600 | 60 | 96 | 72 | 34 | 99 | 44 | 2750 |
| FCULX-4 X 1500E2 HEMP | 4 x 1500 | 277 / 480 | 600 | 60 | 96 | 72 | 34 | 99 | 44 | 2900 |

*All Filter Cabinets are also available in 3 line and 4 line configuration

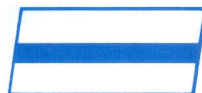



Series FCHS- HEMP Single Individual Filter Elements

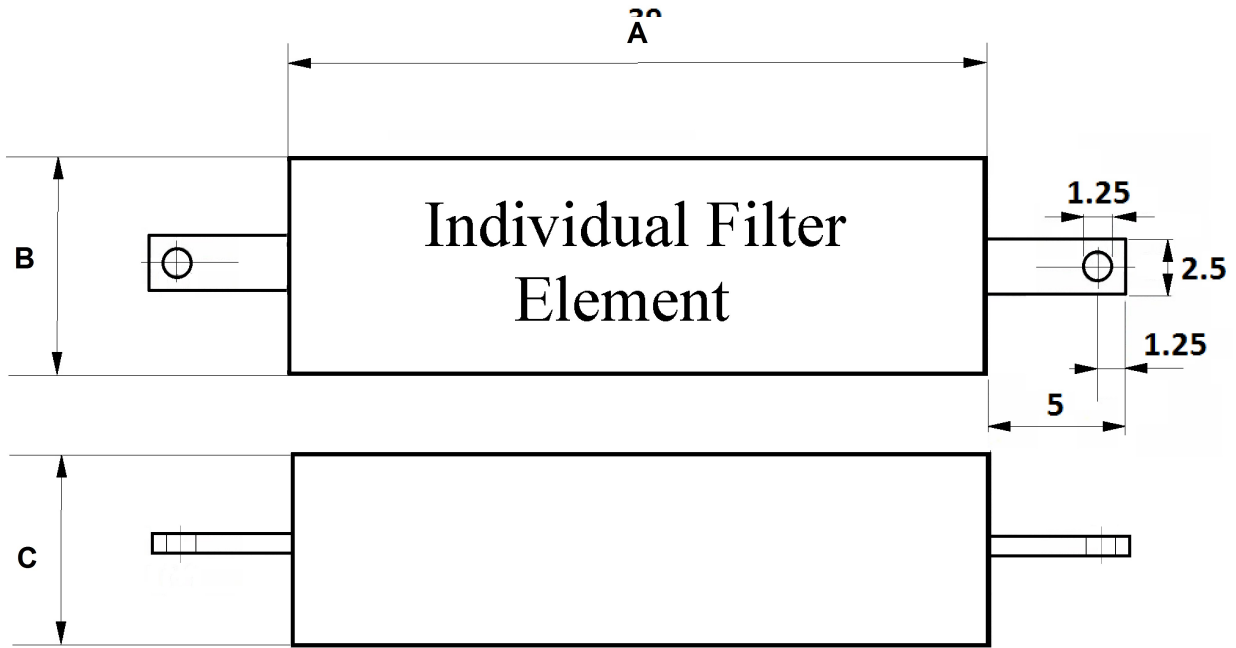

| PART NO | CURRENT RATING (AMP) | VOLTAGE RATING (VAC) | FREQ RATING (HZ) | WIRE SIZE | DIMENSIONS (INCH) | | | INSERTION LOSS (DB) | | | | |
|------------|----------------------|----------------------|------------------|-------------------|-------------------|----|----|---------------------|------|-------|--------|------|
| | | | | | A | B | C | 100kHz | 1MHz | 10MHz | 100MHz | 1GHz |
| FCH-800-E2 | 800 | 277 | 0-60 | 2.5 x 0.5 Bus Bar | 35 | 17 | 14 | 80 | 80 | 80 | 80 | 80 |
| FCH-400-E2 | 400 | 277 | 0-60 | 250MCM | 32 | 16 | 12 | 80 | 80 | 80 | 80 | 80 |
| FCH-100-E2 | 100 | 277 | 0-60 | #2 | 30 | 14 | 10 | 80 | 80 | 80 | 80 | 80 |
| FCH-60-E2 | 60 | 277 | 0-60 | #10 | 28 | 14 | 8 | 80 | 80 | 80 | 80 | 80 |
| FCH-30-E2 | 30 | 277 | 0-60 | #10 | 28 | 14 | 6 | 80 | 80 | 80 | 80 | 80 |





Series FCHS: HEMP Single Individual Filter Elements

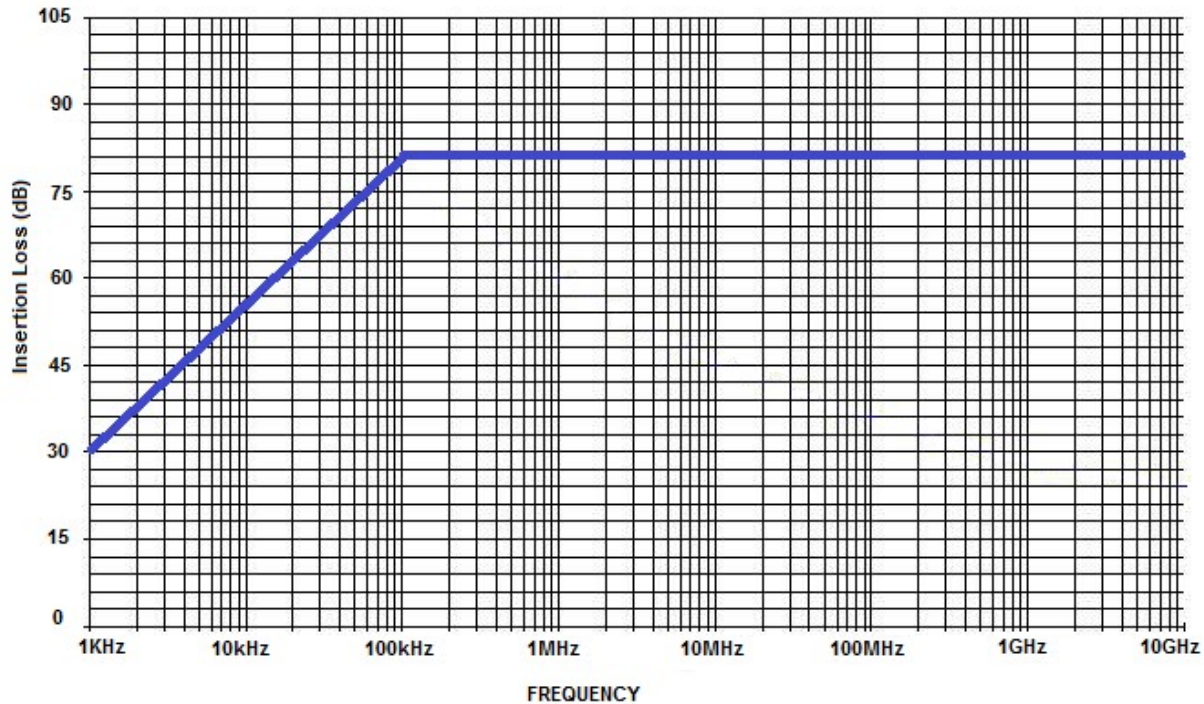

ELECTRICAL

CURRENT RATING: The filters shall be capable of withstanding 140% of rated current for 15 minutes without any deterioration.

INSERTION LOSS: The filter shall provide the specified insertion loss of 80 db minimum over its indicated frequency range when measured in accordance with the applicable MIL-STD-220C by a government approved laboratory.

VOLTAGE: The filters shall be capable of operating continuously at full- rated voltage and of withstanding an initial voltage test of twice the rated voltage for one minute.

MECHANICAL

CASE: The filter case shall be made of cold-rolled steel.

FINISH: All filter cases shall be made corrosion-resistant with suitable lacquer over primer. All unfinished grounding surfaces shall be protected by suitable plating.

IMPREGNANT: The impregnant shall be non-flammable as classified by Underwriters Laboratories.

TERMINALS: The terminals shall be made of high temperature alumina ceramic. The ceramic terminal shall have a flexible insulated lead, one end of which is permanently affixed to the terminal. The other end shall be terminated in a permanently affixed lug which shall be mounted on approved flame-retardant insulator.

OPERATING TEMPERATURE

FILTER ELEMENT: Assembly: from 0°F to 104°F (-18°C to 40°C) at rated voltage and full load operations

Components: from 0°F to 150°F (-18°C to 65°C) at rated voltage and full load operations

